

- NOTES:
- MATERIALS:
 - SHELL: STAINLESS STEEL, T=0.15±0.01mm
 - SPRING: STAINLESS STEEL, T=0.10±0.01mm
 - LATCH: STAINLESS STEEL, T=0.40±0.01mm
 - HOUSING: THERMOPLASTIC
 - MOLDING1: HIGH-THERMOPLASTIC+ BRONZE, T=0.20±0.01mm
 - MOLDING2: HIGH-THERMOPLASTIC+ BRONZE, T=0.20±0.01mm
 - PLATING:
 - CONTACT: CONTACT AREA Au PLATED 30u"Min. OR REFER TO THE PART NO. CODE DEFINED. UNDER PLATE 80u"Min. NICKEL OVERALL. 120u" Min. TIN PLATING ON SOLDER TAIL
 - SHELL: 30u"Min. NICKEL PLATING OVERALL
 - ELECTRICAL PERFORMANCE:
 - INSULATION RESISTANCE: 100Mohm MIN.
 - CONTACT RESISTANCE: 40mohm MAX.
 - DIELECTRIC WITHSTANDING: 100 VAC
 - CURRENT RATING: 3A MIN.
 - MECHANICAL PERFORMANCE:
 - MATING FORCE: 5-20N
 - UNMATING FORCE: 8-20N
 - DURABILITY: 10000 CYCLES

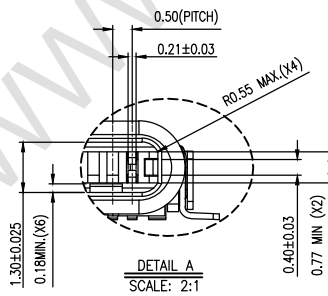
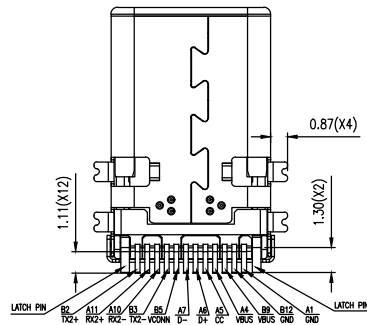

DESIGN	MISS ZENG	SC ALL		未注公差 T00LERANCE
DRAWIGN	MISS LI	ANIT	MM	
CHECK	Mr. ZENG	SIZE	A4: 210*297	
APPROVAL		VERSION	01	

品名: 连接器
 型号: TYPE-C 12P四脚贴板公头
 L=13.18

东莞市航宏电子科技有限公司
 Dongguan Hanghong Electronics Co., Ltd.