

F E D C B A

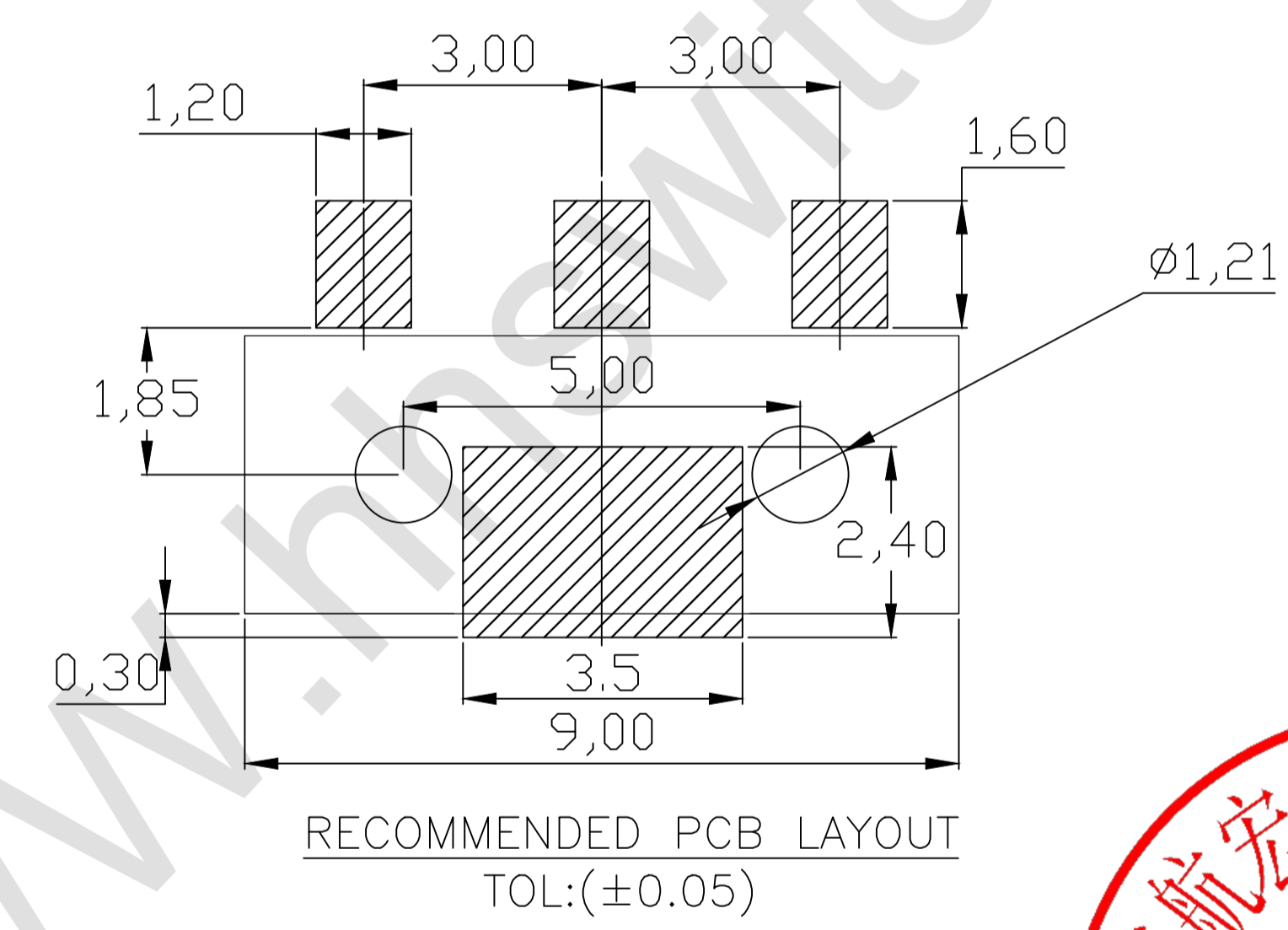

性能:

- 额定电流: 2.0A
- 额定电压: 12V
- 耐电压: 500V
- 接触电阻: 30mΩ
- 绝缘电阻: 500MΩ
- 工作温度: -40℃~+85℃
- 零件(材质): LCP
- 接触点(材质): 磷铜, 镀金3U"

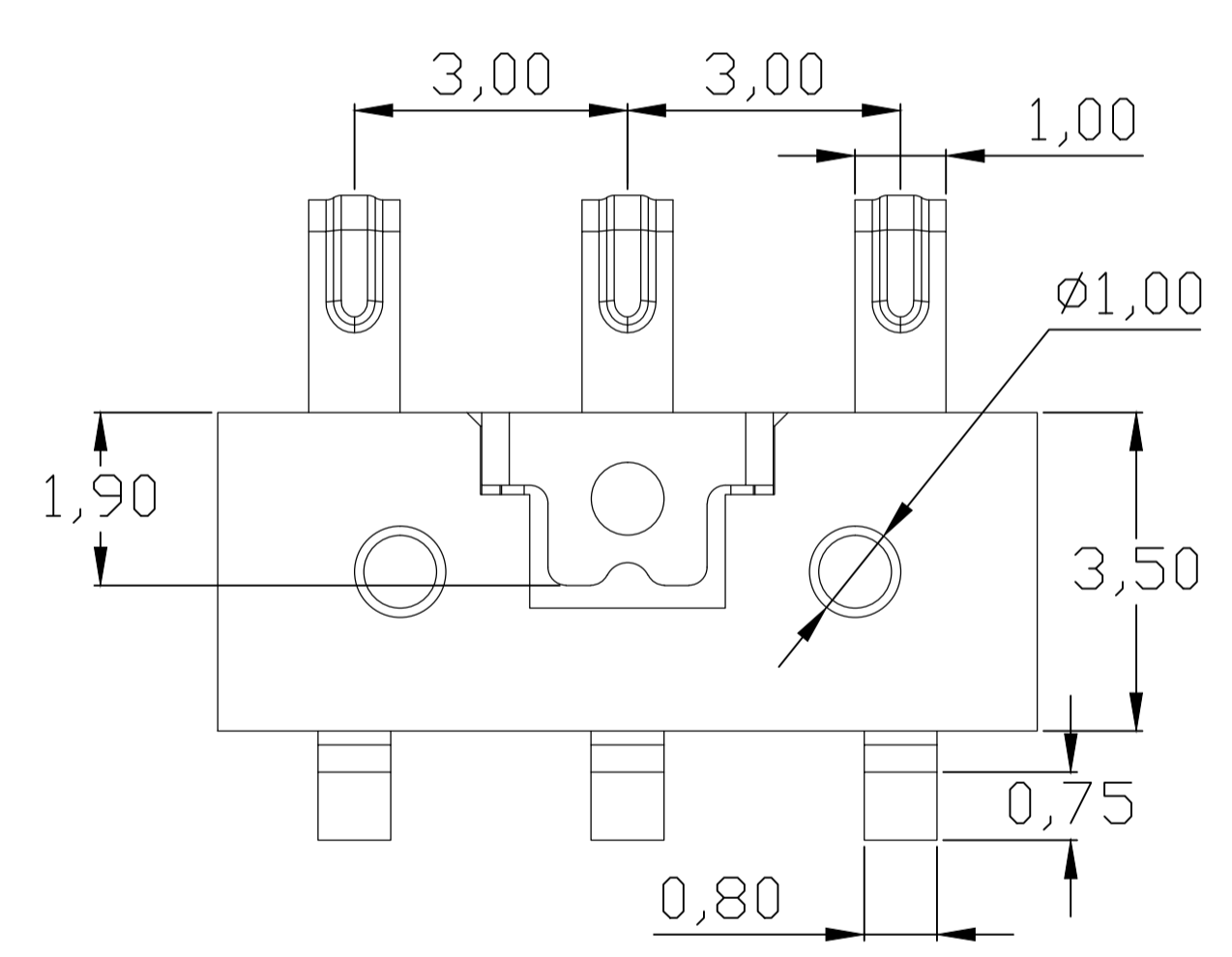
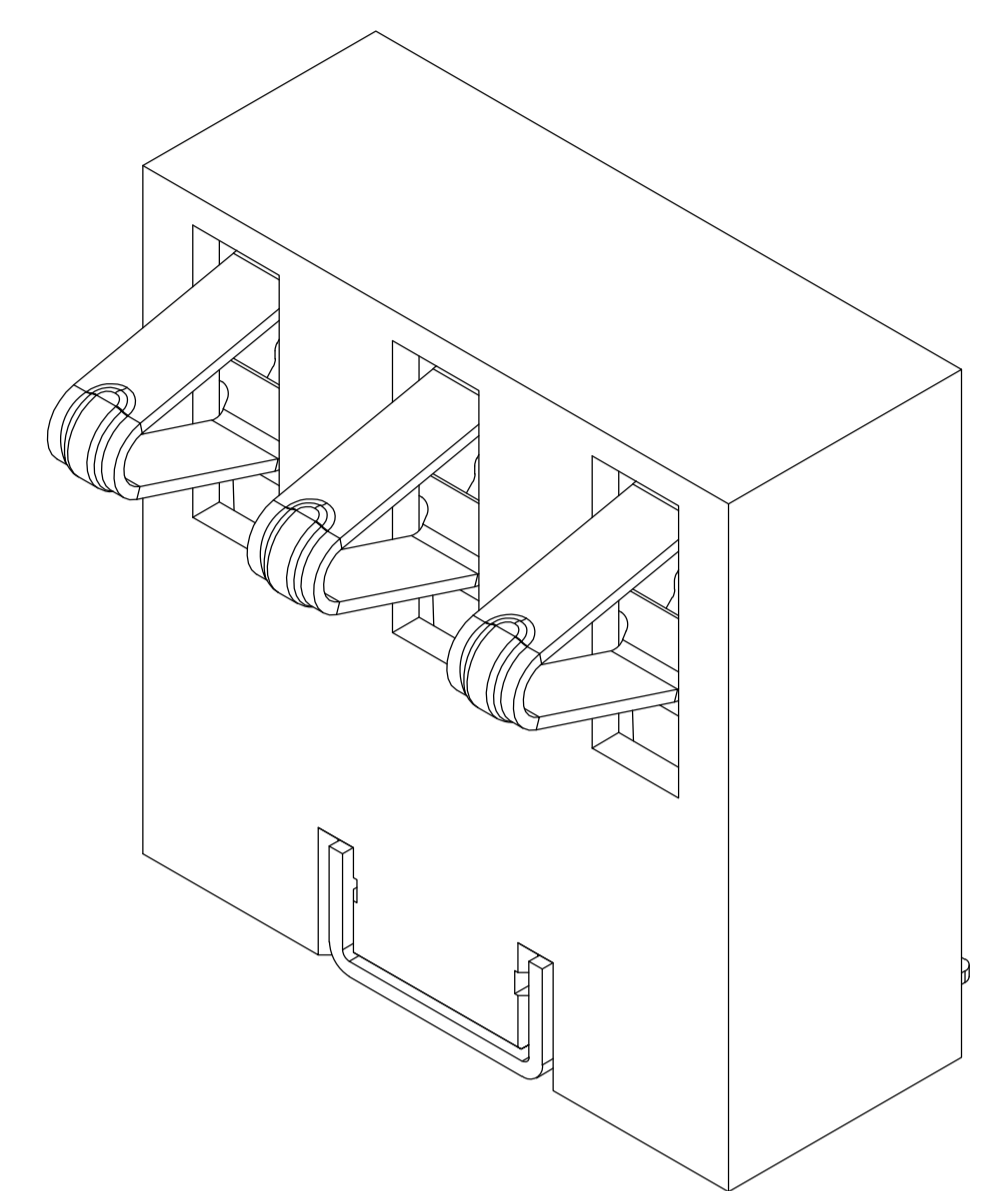
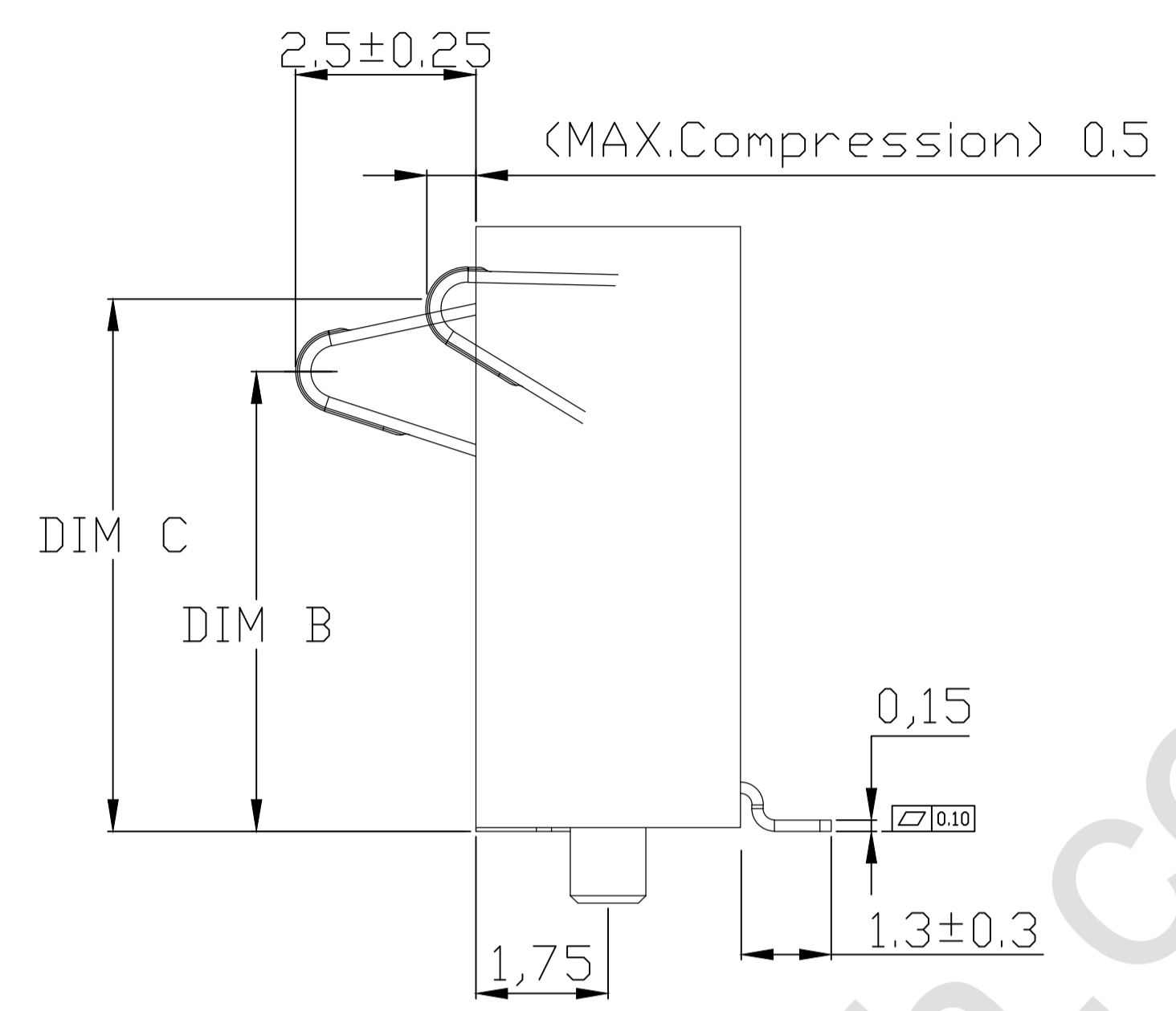
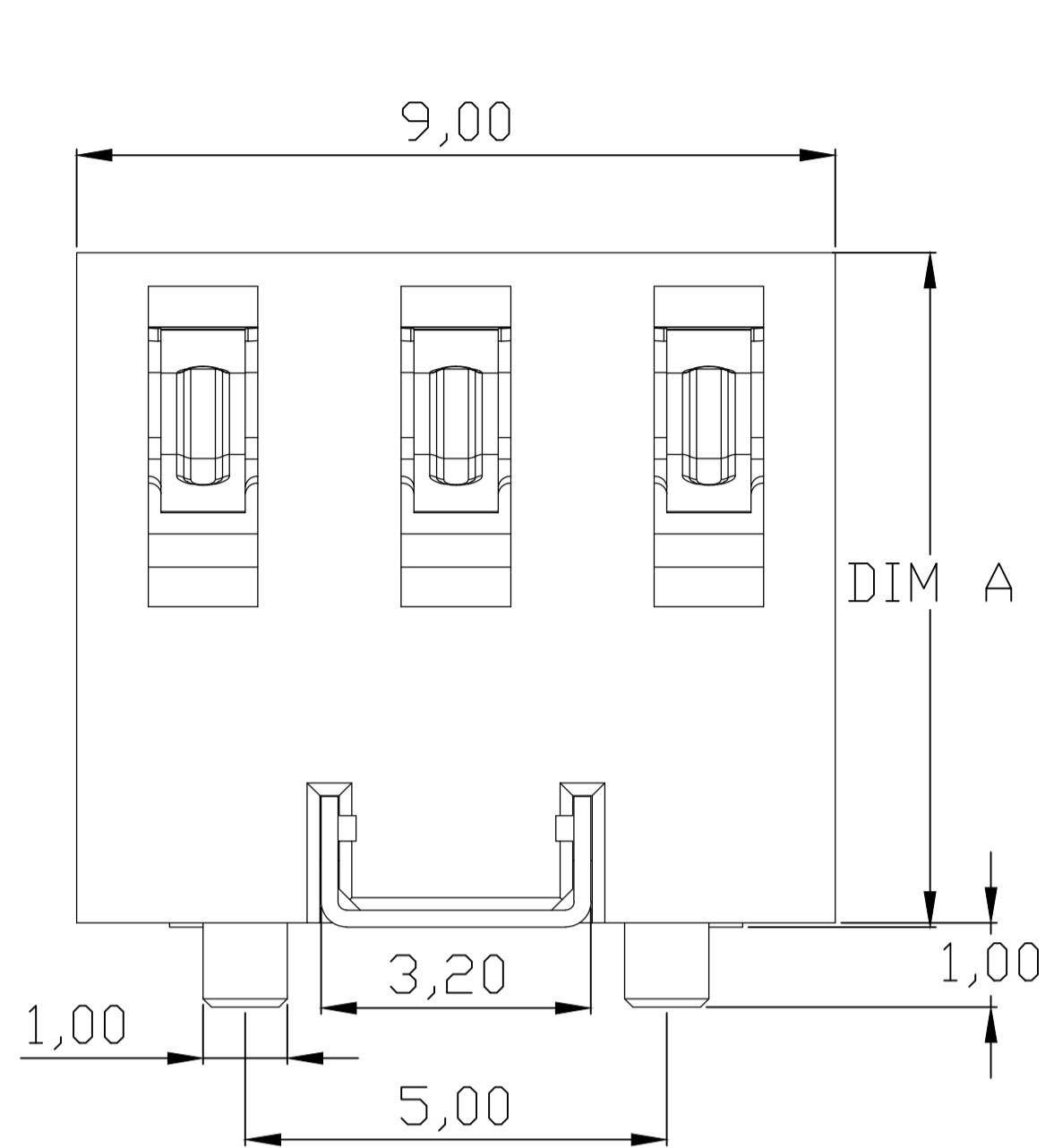

规格型号	DIM A	DIM B	DIM C
BHC030-3PD800	8.0±0.15	5.9±0.3	6.9±0.3
BHC030-3PD900	9.0±0.15	6.9±0.3	7.9±0.3
BHC030-3PD100	10.0±0.15	7.9±0.3	8.9±0.3

DESIGN	MISS ZENG	SC ALL		未注公差 T00LERANCE		品名: 电池连接器	
DRAWIGN	MISS LI	ANIT		MM	X. ±0.35		X.XX ±0.15
CHECK	Mr. ZENG	SIZE		A4: 210*297	X. X ±0.25		X. XXX ±0.05
APPROVAL		VERSION		01			

品名:	电池连接器
型号:	BHC030-3PD900

东莞市航宏电子科技有限公司
Dongguan Hanghong Electronics Co., Ltd.

F E D C B A